

# STEEL - LADDER - STRAIGHT LENGTH

## CSA CLASS C

Trays are constructed from pre-galvanize steel.



LADDER			
Rung Spacing		Width	
cm	in	cm (W)	in
15	6	15	6
22	9	30	12
30	12	45	18
45	18	60	24
		75	30
		90	36

\*Imperial measurements are for reference only  
\*Custom width available on request

HOW TO ORDER - EXAMPLE: SLC30-30				
Steel	Ladder	Class	Rung Space	Width
S	L	C	30	30
S	L	C6	30	30

\*Length is 3 meters

			CSA C22.2 #126.1-98	
			Span, m (ft)	Load kg/m (lb/ft)
SLC		SLC6	3 m (10 ft)	97 kg/m (65 lb/ft)
SLC6				

## SPYDERLOK

The original quick connector included with all fittings and tray.

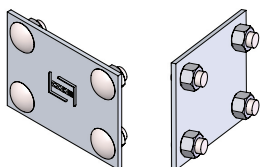

## RUNG PROFILE

