

# STEEL - VENTILATED - STRAIGHT LENGTH

## CSA CLASS E

Trays are constructed from pre-galvanize steel.



VENTILATED			
Rung Spacing		Width	
cm	in	cm (W)	in
5	2	15	6
		30	12
		45	18
		60	24
		75	30
		90	36

HOW TO ORDER - EXAMPLE: SVE-30			
Steel	Ventilated	Class	Width
S	V	E	30
S	V	E6	30

\*Length in 3 meters

\*Imperial measurements are for reference only  
\*Custom width available on request

\*Max 50mm / 2" spacing between rungs

CSA C22.2 #126.1-98	
Span, m (ft)	Load kg/m (lb/ft)

SVE			3 m (10 ft)	299 kg/m (200 lb/ft)
SVE6			3 m (10 ft)	299 kg/m (200 lb/ft)

## SPYDERLOK

The original quick connector included with all fittings and tray.

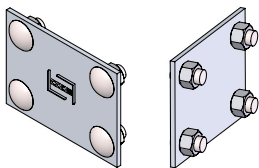

## RUNG PROFILE

